

FORTY3 BASIN FO063BI

CE EN 14688:2015

GLOBO

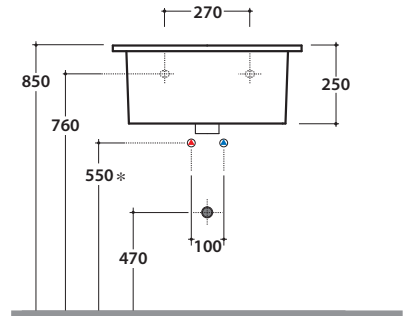
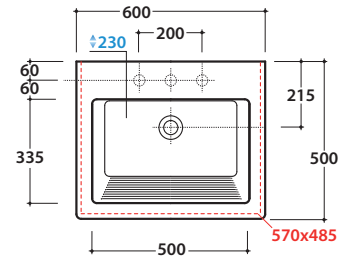

*For taps mounted on counter top



Ceramic antibacterial effect
BATAFORM®



Glazed product with
CERASLIDE®

Cod. **FO063BI**

Basin 60.50 h25 cm. With high sink and wringer. Wall-hung installation or on base. Fixing kit included. Weight 26 Kg



Cod. **FI012BI**

Push open valve drain with ceramic top for basins with overflow. Weight 0,5 Kg



Cod. **FI012CR**

Push open chromed valve drain for basins with overflow. Weight 0,5 Kg